



LEUPHANA VERANSTALTUNGS- UND
VERMARKTUNGSGESELLSCHAFT mbH

FACTSHEETS

LEUPHANA ZENTRALGEBÄUDE





THE LEUPHANA ZENTRALGEBÄUDE

Are you looking for a venue for your next congress, trade fair, exhibition, incentive, theatre or concert? The new Leuphana Zentralgebäude makes your event with its extraordinary premises a special experience.

This unique building was designed by the famous architect Daniel Libeskind, who is also known for designing the Jewish Museum Berlin and is the winner of the competition for the new One World Trade Center. The design surely breaks with the usual perception and makes people talk.

External events were a main criterion in the planning. The Libeskind Auditorium has a total of 1,001 seats and an automatically extendable stand, which can accommodate 730 visitors. It also has a large screen and a stage (18 x 7 x 1 m) that can be adapted to your needs. Illuminated transverse axes guarantee a great atmosphere. All 12 seminar rooms (8 to 72 seats with parliamentary seating) offer you an extraordinary feeling of space and a breathtaking view.

For maximum flexibility, you can connect the rooms on the ground floor by opening wall elements. A total of over 2,000 m² is available for your event.



AREAS ON THE GROUND FLOOR



With over 2,000 m², the ground floor of the Leuphana Zentralgebäude is a real space miracle. With flexibly usable gates, you can combine the three rooms on the ground floor to create an extraordinary event area. The reduced yet high-quality equipment complements the exclusive overall impression. This building irritates in many ways by breaking with habits in many details. It is a building that brings people together in many different ways.

„It gives people an entire new spectrum of possibilities from the very very intimate and very personal to the grand and very very public [...]” Daniel Libeskind, architect

Let your event become something special!

Number of persons according to seating

ROOM	AREA IN M ²	RECEPTION	ROWS	PARLIAMENTARY	GALA
Libeskind Auditorium	920	1400	1001*	310**	450
Leuphana Forum	450	600	200	100	200
Leuphana Foyer	830	1.000	300	150	300

* Each seat is equipped with a folding table

** Special Seating

The floor:

The whole ground floor is fitted with high-quality, hard-wearing oak parquet.



THE LIBESKIND AUDITORIUM



The Libeskind Auditorium is the heart of the Leuphana Zentralgebäude and is ideal for events such as concerts, theatre, exhibitions and congresses. Each seat is equipped with a folding table (21 x 15 cm). Thanks to the architectural design with illuminated transverse axes (LED), the Libeskind Auditorium offers an atmospheric setting for any of your events. A hydraulic stand opens up the possibility of e.g. opening the room or changing from parliamentary seating to gala seating at short notice.

OVERVIEW

Capacity: Seated (grandstand): 730 seats
 Seated (total): 1.001 seats
 Not seated: 1.400 seats

Area: 920 m² without grandstand,
 without stage (1.500 Pax)
 665 m² without grandstand,
 with stage (1.350 Pax)

Equipment: projector, projector screen, microphone system

Technology: See page 9

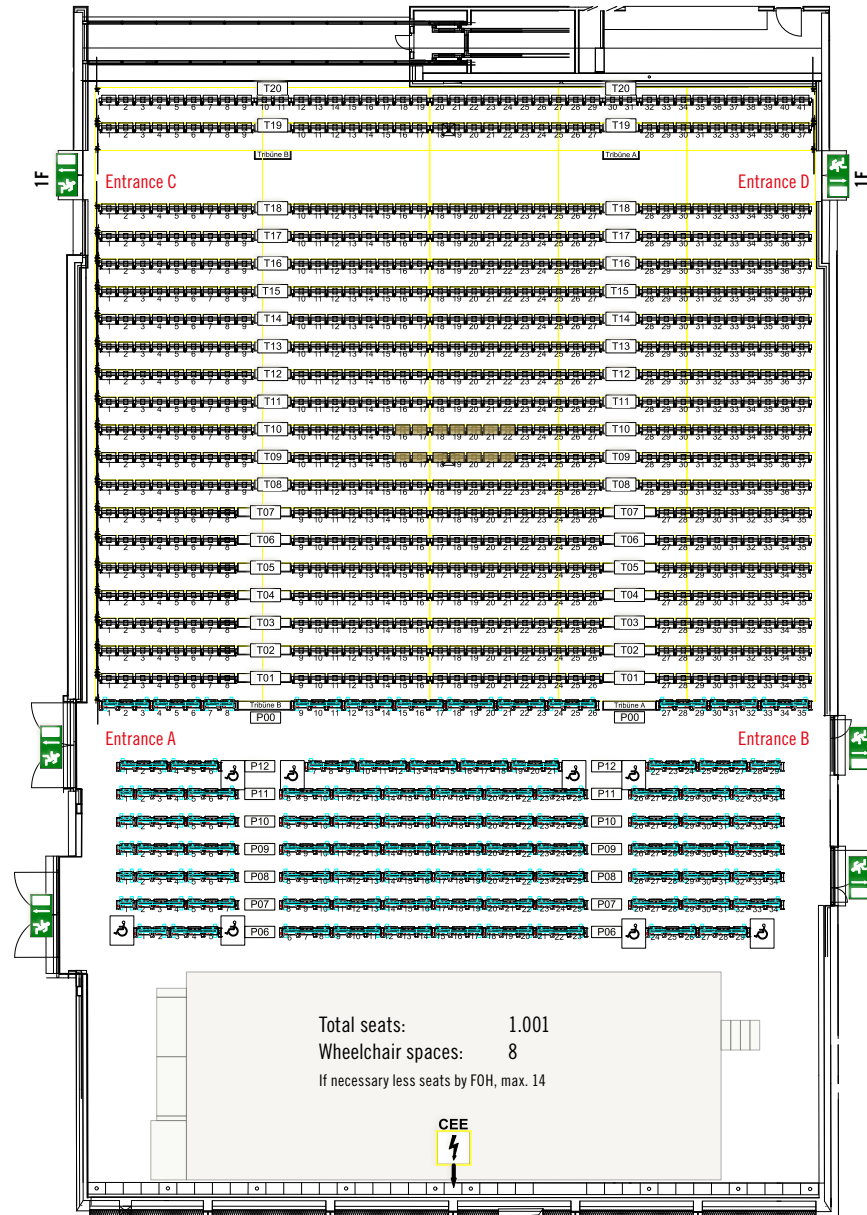

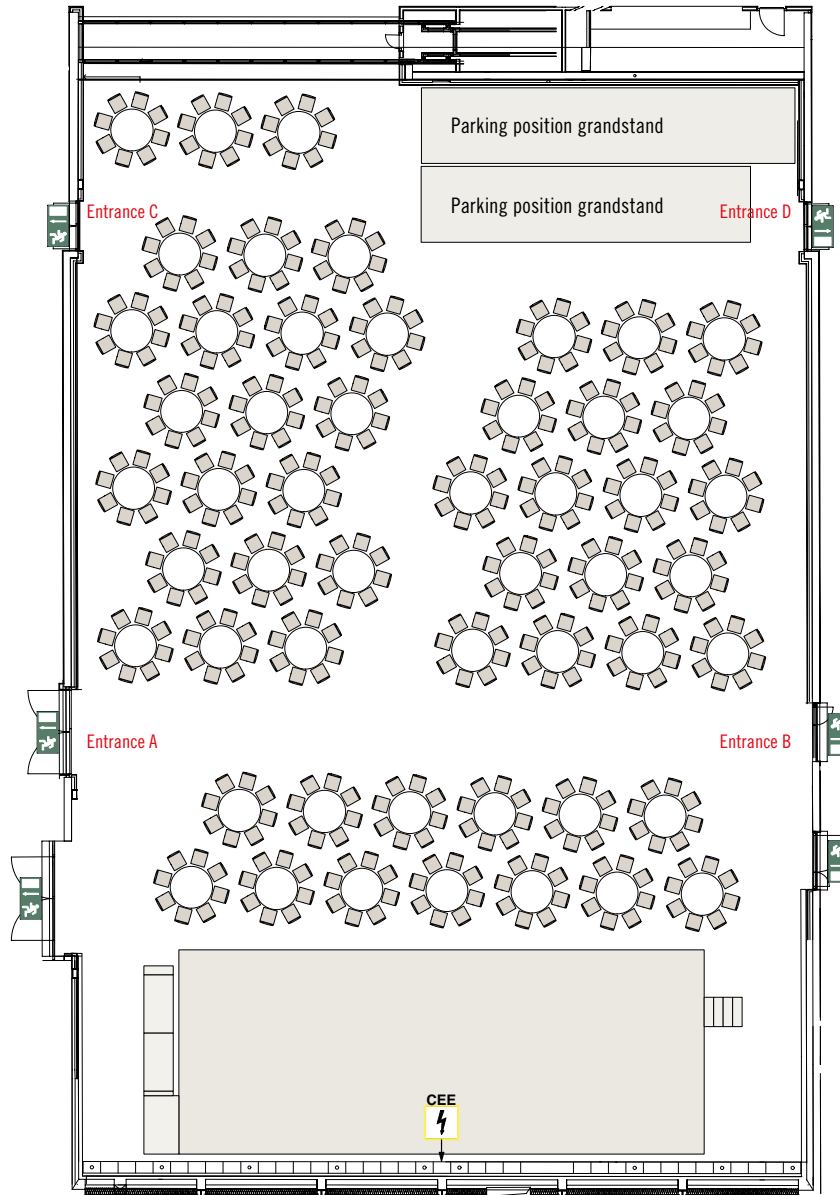

Example gala seating, without grandstand, with stage.

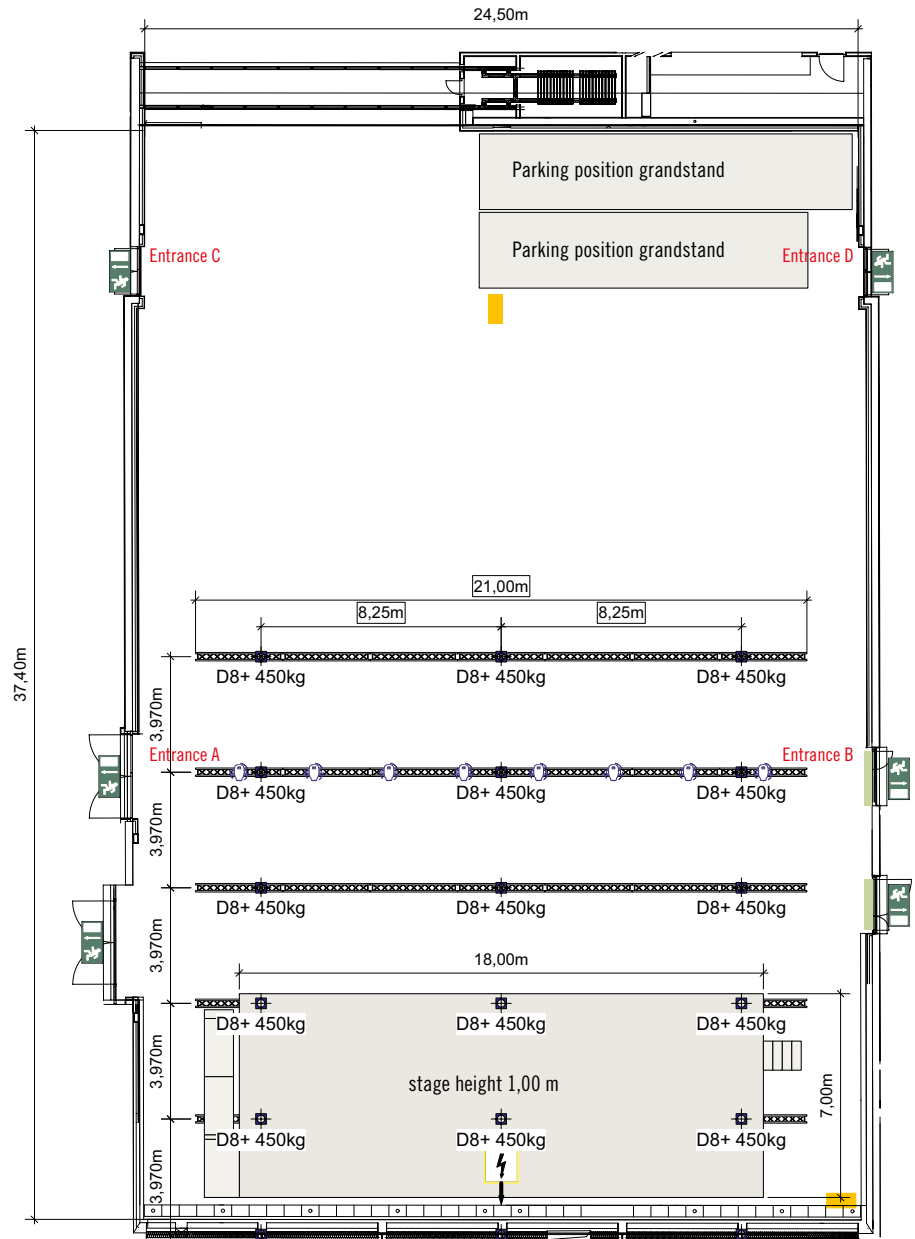

Example without seats, without tribune, with stage.

Local Multicore

TECHNICAL EQUIPMENT

Video equipment:

- Panasonic PT-DZ21K2 fixed 20k ANSI lumen sound-proof video projector
- Mobile 12x10 m screen at the front

Sound system:

Processor-controlled QSC line array, flown:

- 12x ILA WL2082-i Line Array Module
- 2x ILA WL118sw Line Array Subwoofer
- 2x 12" delay
- 2x 12" nearfill

Lighting

- Room lighting and decorative light strips, controllable and storable via mobile touch panel
- 1 x light traverse with 8 Martin Encore Performance WRM moving lights
- DMX 5-pole transfer point in the floor tank under the FOH in the balcony or in the middle under the stage

Stage

- MOTT Praktikus stage system 18x7m with railing and noble wood paneling, stairs and wheelchair ramp. (See stage plan).
- Height of stage: 1,0 m
- Expandable or modifiable on request.

Rigging

- 5x 21m FD34 crossheads on 3x 500kg Chainmaster D8+ motors each, see crosshead plan
- 1x 18m lateral FD34 cable traverse on 3x 160kg D8+ Chainmaster motors
- Further load points can be reached on request and only with a special hoist
- Clear height of floor to traverse lies between 11.30 m and 10.80 m

FOH + signal routing

- Mobile FOH tables with offset flap for multicore in the grandstand
- Recessed multi-core channel from the stage to the FOH
- Various floor tanks, offsets for signal routing, Cat, SDI, NF, more exact specifications on request

Electricity

Three-phase current connections in the stage area:

- 2x 125A/CEE
- 2x 63A/CEE
- 2x 32A/CEE
- various European standard connectors in the floor and on the walls

Accessibility

The seating in the parquet is completely barrier-free



THE LEUPHANA FOYER



Above the Leuphana Foyer is a surrounding gallery with breathtaking views of the Leuphana Foyer and the Leuphana Forum as well as space for separate receptions. Next to the main entrance on the Universitätsallee is a second entrance, which is accessible via the Central Campus. You can use the Leuphana Foyer without interior decoration or set up furniture wherever you want. In combination with the Libeskind Auditorium and the Leuphana Forum you have space for approx. 2,500 people on the ground floor alone.

OVERVIEW

Capacity: 1.000 People (Reception)
Area: 830 m²
Seating : Individual
Equipment: None

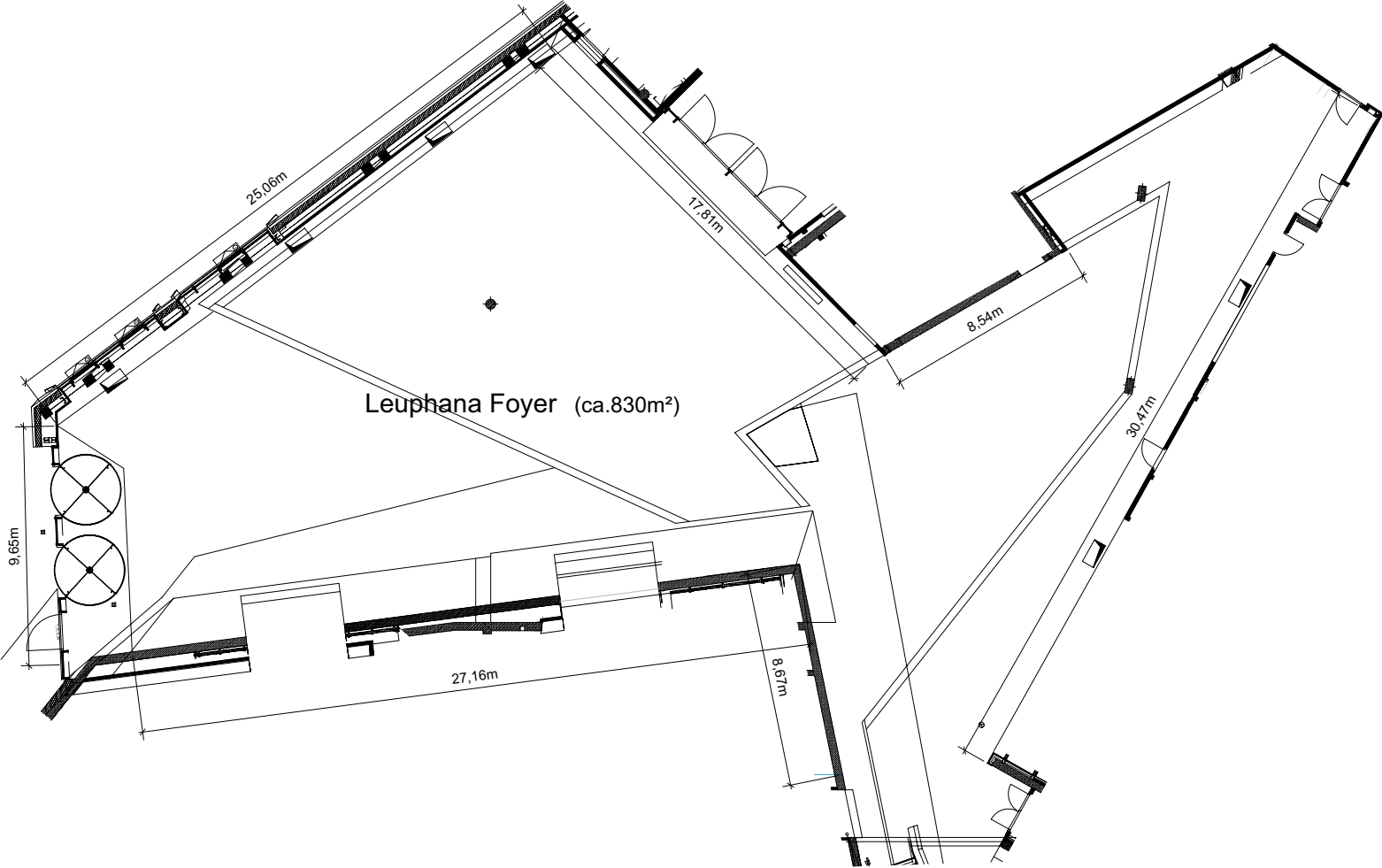

THE LEUPHANA FORUM

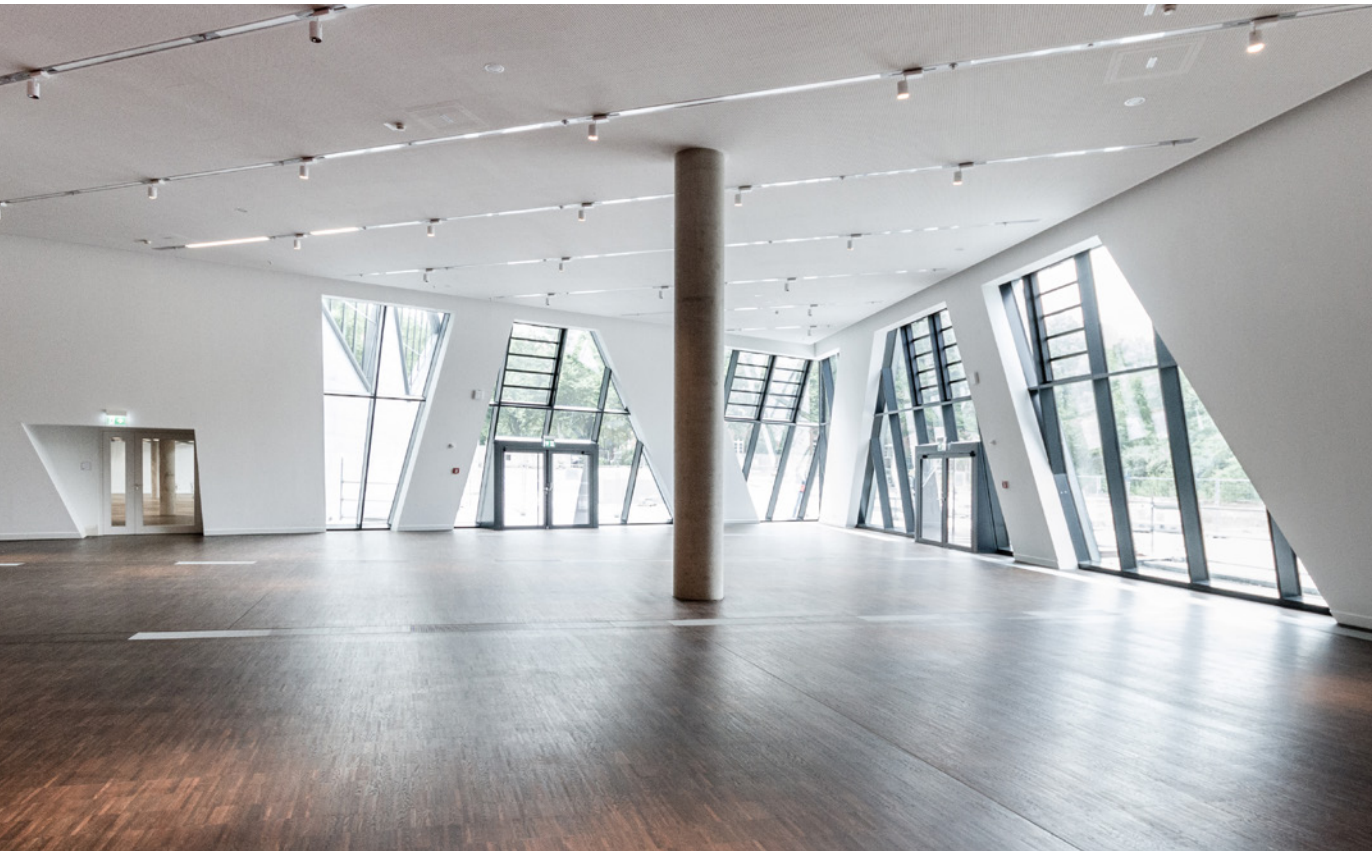

The Leuphana Forum convinces with its unique architecture, the free view of the outdoor area and the various possibilities of use. It offers enough space for events such as exhibitions, trade fairs or conferences. The interior can be designed according to your wishes. In combination with the Leuphana Foyer there is even more space for your events.

OVERVIEW

Capacity: 600 People (Reception)
Area: 450 m²
Seating: Individual
Equipment: None

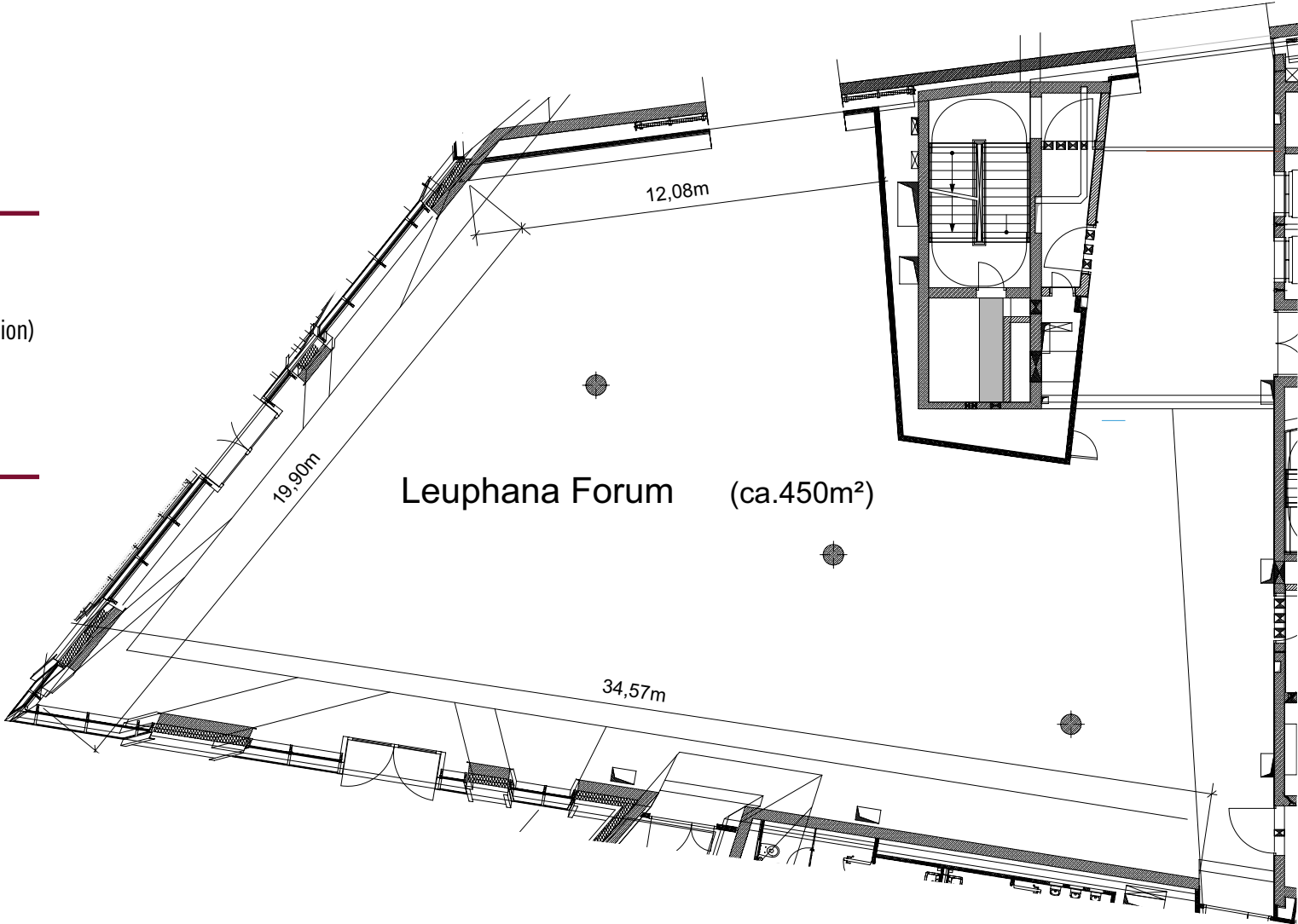

THE CAFETERIA



OVERVIEW

Capacity: 132 Seats
Extras: 80 Seats Terrace

If you have any question about renting the cafeteria,
please contact the team of the LVV GmbH.

OVERVIEW OF ALL ROOMS IN THE LEUPHANA ZENTRALGEBÄUDE

FLOOR	DESCRIPTION	ROOM	CAPACITY parliamentary
1F	Seminar room	C 40.108	32
1F	Seminar room	C 40.146	28
1F	Seminar room	C 40.147	16
1F	Seminar room	C 40.152	24
1F	Seminar room	C 40.153	22
1F	Seminar room	C 40.154	30
1F	Seminar room	C 40.162	18
1F	Seminar room	C 40.164	22
1F	Seminar room	C 40.165	35
1F	Seminar room	C 40.175	18
1F	Seminar room	C 40.176	16
2F	Seminar room	C 40.254	22
2F	Seminar room	C 40.255	40
2F	Seminar room	C 40.256	58
5F	Seminar room	C 40.501	140*
5F	Terrace including C 40.530	C 40.530	30
6F	Seminar room	C 40.601	70*
6F	Seminar room	C 40.606	115*
7F	Seminar room	C 40.704	72

FLOOR	DESCRIPTION	KAPAZITÄT parliamentary
GF	Libeskind Auditorium	310**
GF	Leuphana Foyer	250
GF	Leuphana Forum	150
GF	Leuphana Foyer + Forum	400
GF	Gastronomy/restaurant	132
GF	Gastronomy/terrace	80

* row seating
** Special Seating



MORE INFORMATION



- Catering** A high-quality in-house caterer is available for your event. You can choose your individual caterer against payment of cork money.
- Wardrobe** No liability is assumed for the wardrobe.
- Wi-Fi** Free Wi-Fi with a connection speed of up to 1 GB/s is available for guests.
- Cleaning** Will be charged as required.
- Power consumption** Calculated according to consumption.
- Parking spaces** There are many parking spaces on the Leuphana Campus. During the semester, these are only available to a limited extent during the day.

SUSTAINABILITY / SUSTAINABLE EVENTS

The Leuphana University of Lüneburg sees it as its task to set an example of responsibility in teaching, research and university life. This applies to small things as well as to larger things up to a global challenge. The university is home to the only sustainability faculty in German-speaking countries.

When Daniel Libeskind designed the building, the focus was on the economical use of electricity, especially in lighting, ventilation and cooling. The house façade is inclined to the sun, which leads to shading and passive cooling in summer. This, in combination with the switchable glazing, eliminates the need for mechanical air conditioning. You can open the windows manually; CO₂ indicators help with proper ventilation. The result is an unimportant cooling requirement with pleasant temperatures throughout the building and enormous power savings.

Climate neutrality

The energy required for the rest of the building is generated through the use of 100% renewable energy sources, just like the other buildings on campus. The heat comes from a combined heat and power plant that produces much more electricity than is required; solar cells produce an energy surplus that is used internally and already covers 25% of the required energy.

Durability is particularly important: concrete is sensitive to rain and wind. The rear-ventilated zinc façade reflects heat and cold and keeps the building dry - so that generations of students, scientists and other people can use the new premises.

Set an example

Organize your event with sustainability in mind. More information under: [Leuphana.de/veranstaltung](https://www.leuphana.de/veranstaltung) (German!)



ACCESS TO THE CENTRAL CAMPUS

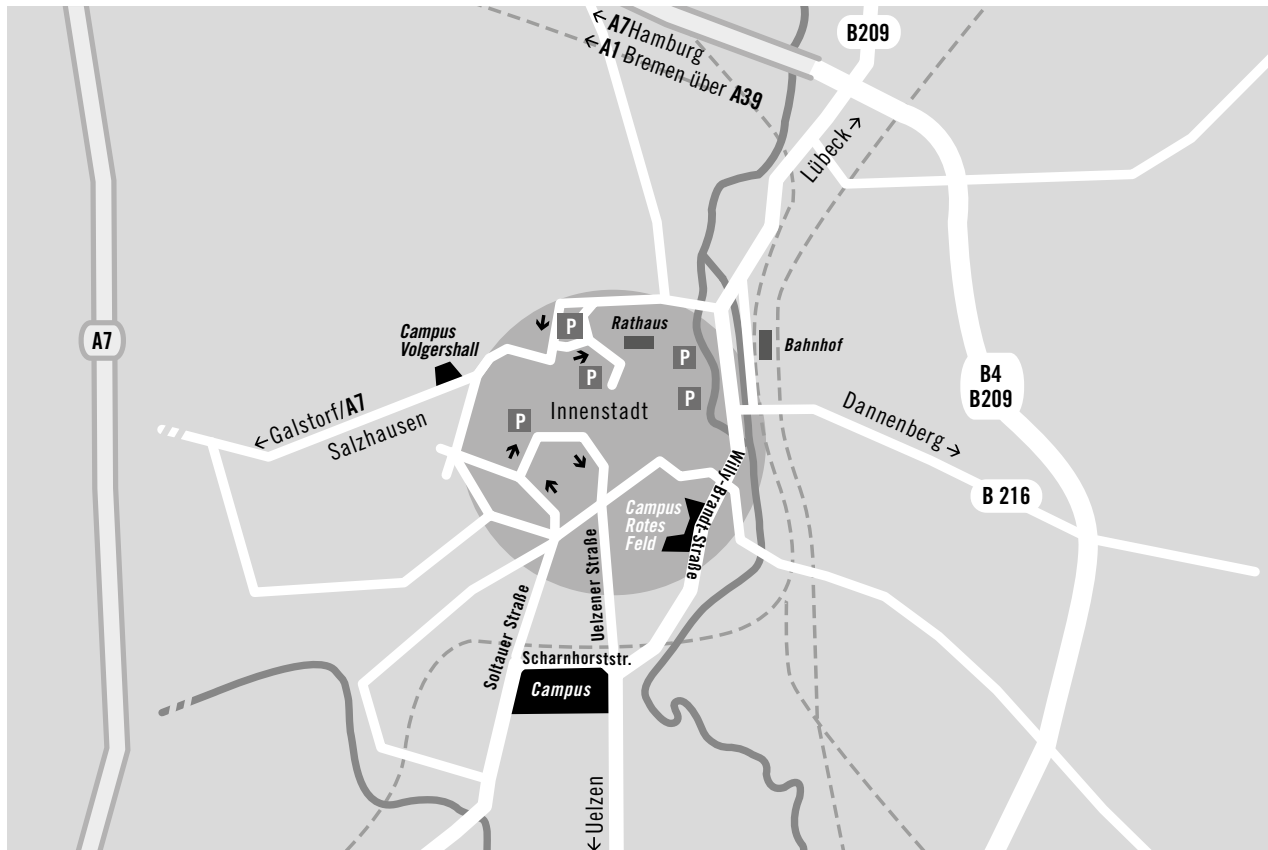

BY TRAIN & BY BUS

Lüneburg is situated on the main railway route between Hanover and Hamburg.

An ICE train takes about one hour from Hanover. From Hamburg you can take the IC or ME (Metronom, regional fast track) to Lüneburg in 30 minutes. Lüneburg is part of the catchment area of the Hamburger Verkehrsverbund (HVV).

During the lecture period the bus line 5001 runs as a direct shuttle connection from Lüneburg train station to the Central Campus. The bus line 5600 (to Barnstedt) also goes to campus. You have to get off at the bus stop "Universitätsallee". The bus lines 5011 in the direction of Rettmer Häcklingen and 5012 in the direction of Bockelsberg can also be used, the final stop is always Blücherstraße. See also map p. 19.

In addition, there are taxis waiting in front of the train station. A ride to the Central Campus costs approx. 8 to 10 €.

BY CAR

From the South: Follow the federal motorway A7 Hanover - Hamburg until you reach the Soltau-Ost exit, from there take the state highway 209 to Lüneburg. Then follow the road signs to the university campus.

From the North: Follow the federal motorway A39 Hamburg - Lüneburg and then onto the eastern bypass to the Lüneburg - Häcklingen exit. Then follow the road signs to the university campus.

Parking: Please obey the parking regulations on campus and park your car in a designated car park. Illegally parked cars will be towed.

BY PLANE

The nearest airports are Hamburg (70 km), Hanover (120 km) and Bremen (150 km).

All three airports can be easily reached by public transport. In Hamburg, the urban train (S-Bahn) runs every 10 minutes to the main station. The ride takes about 25 minutes. In Hanover the S-Bahn leaves every 30 minutes and takes about 20 minutes to the main station. In Bremen, the tram line 6 leaves for the main station every 10 minutes.

MAP OF CAMPUS

CENTRAL CAMPUS



CONTACT INFORMATION

**Leuphana Veranstaltungs- und
Vermarktungsgesellschaft mbH**
Campus Center
Heinrich-Böll-Straße 34a
21335 Lüneburg
Fon 04131.156 14-12
Fax 04131.156 14-20
E-Mail buero@lvv.gmbh
www.zentralgebaeude.de

IMPRINT

Leuphana Veranstaltungs- und Vermarktungsgesellschaft mbH
Campus Center, Heinrich-Böll-Straße 34a, 21335 Lüneburg
CONCEPT AND EDITING: LVV GmbH
DESIGN: Anke Sudfeld
PHOTOCREDITS: Leuphana Universität, LVV GmbH, p9 (top); p10: Ludwig Moos

**Leuphana Veranstaltungs- und
Vermarktungsgesellschaft mbH**
Campus Center
Heinrich-Böll-Straße 34a
21335 Lüneburg

» zentralgebäude.de

